

# LandRover 2014 VES Carplay

---

- MODEL : HW Ver 83
- DATE : 2020.09.15



**GU ELECTRONIC**

# Index

---

1. Main Spec
2. Block Diagram
3. Dimension
4. External Appearance
5. Connector Pin Assignment
6. Product Composition
7. DIP S/W Setting
8. Install Manual
9. Q & A

# 1. Main Spec.

---

1. Input Spec. (MULTI VIDEO INTERFACE)
  - 1 x Carplay Wireless / USB
  - 1 x LVDS Input. (Car Command System)
2. Output Spec.
  - 1 x LVDS Output (LCD Operation)
3. Power Spec.
  - Input Power : 8VDC ~ 24VDC
  - Consumption Power : 12Watt, Max
4. Switch Input mode
  - Possible to select CAR model while switching mode by DIP S/W
  - By button on the Commander in the car via CAN
5. Note: This product does not support front and rear cameras

## 2. Block Diagram

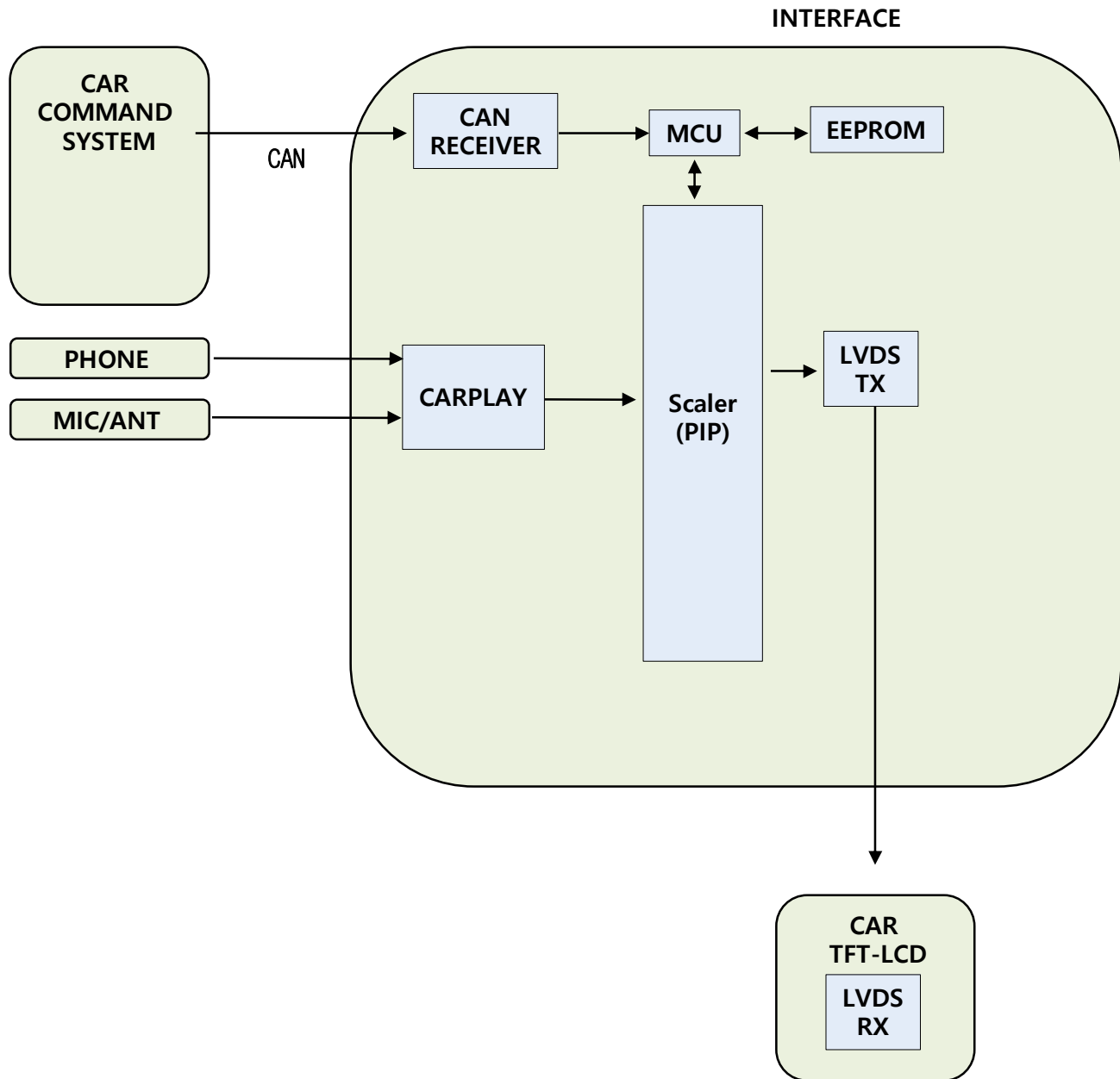

### 3. Dimension

153mm \* 79mm \* 21mm

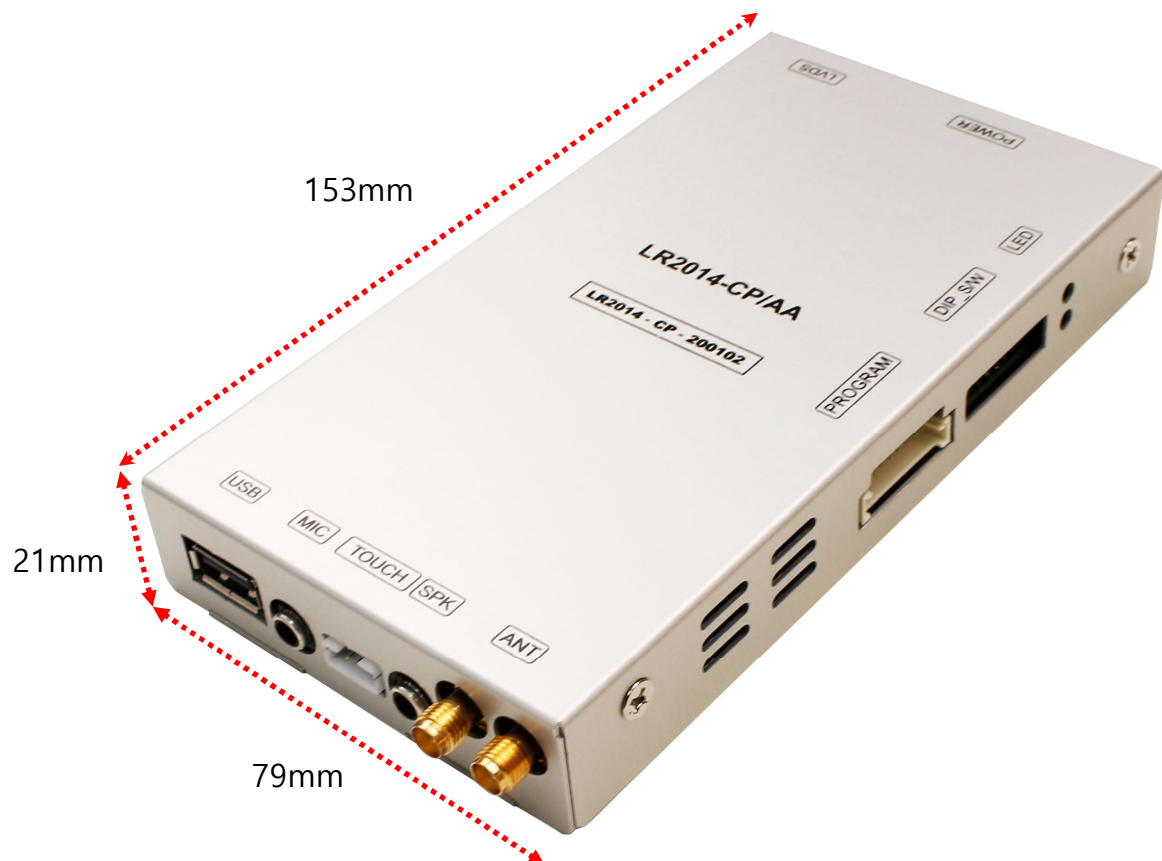

\* This can change under manufacturer's circumstance

## 4. External Appearance

---

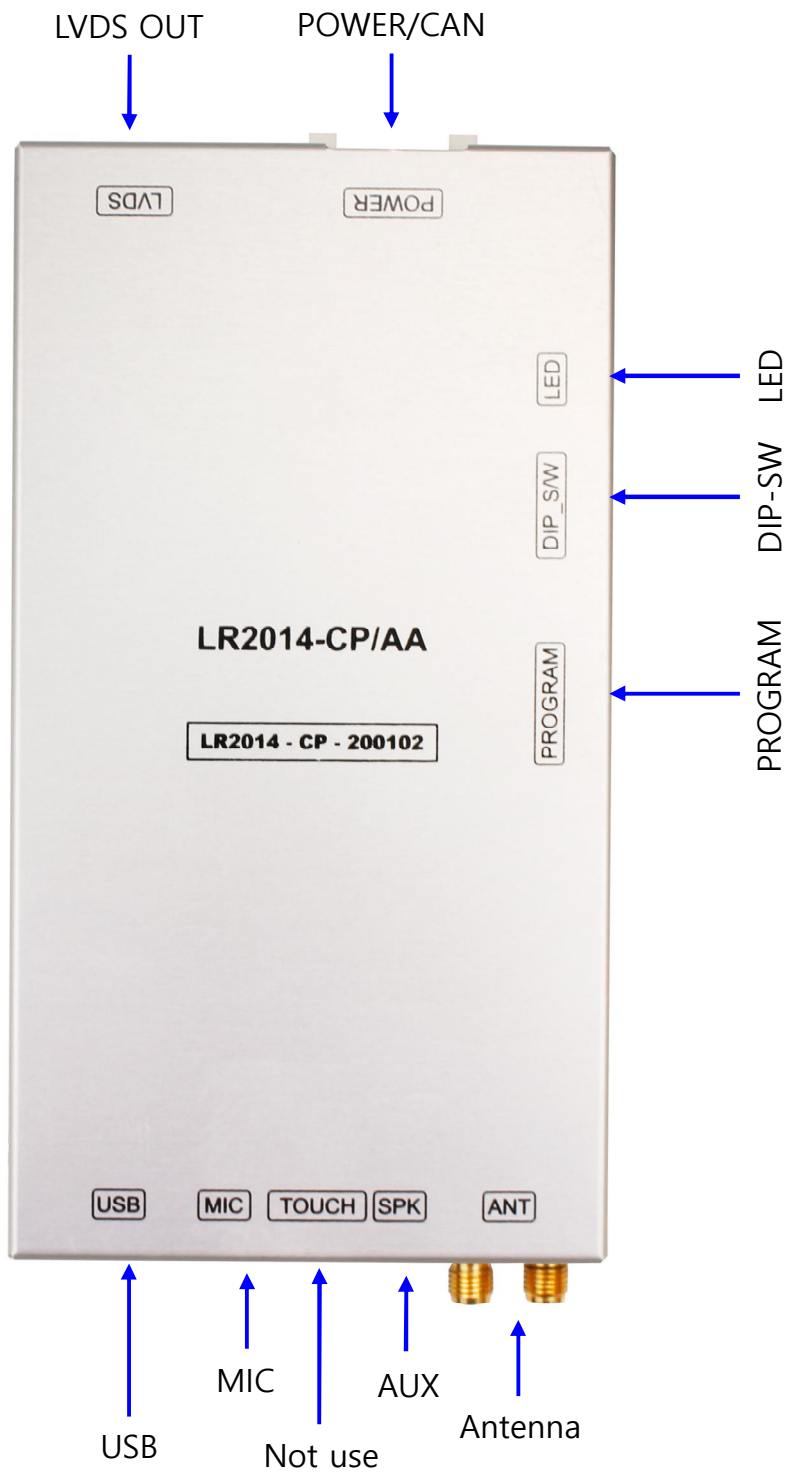

## 4. External Appearance

---

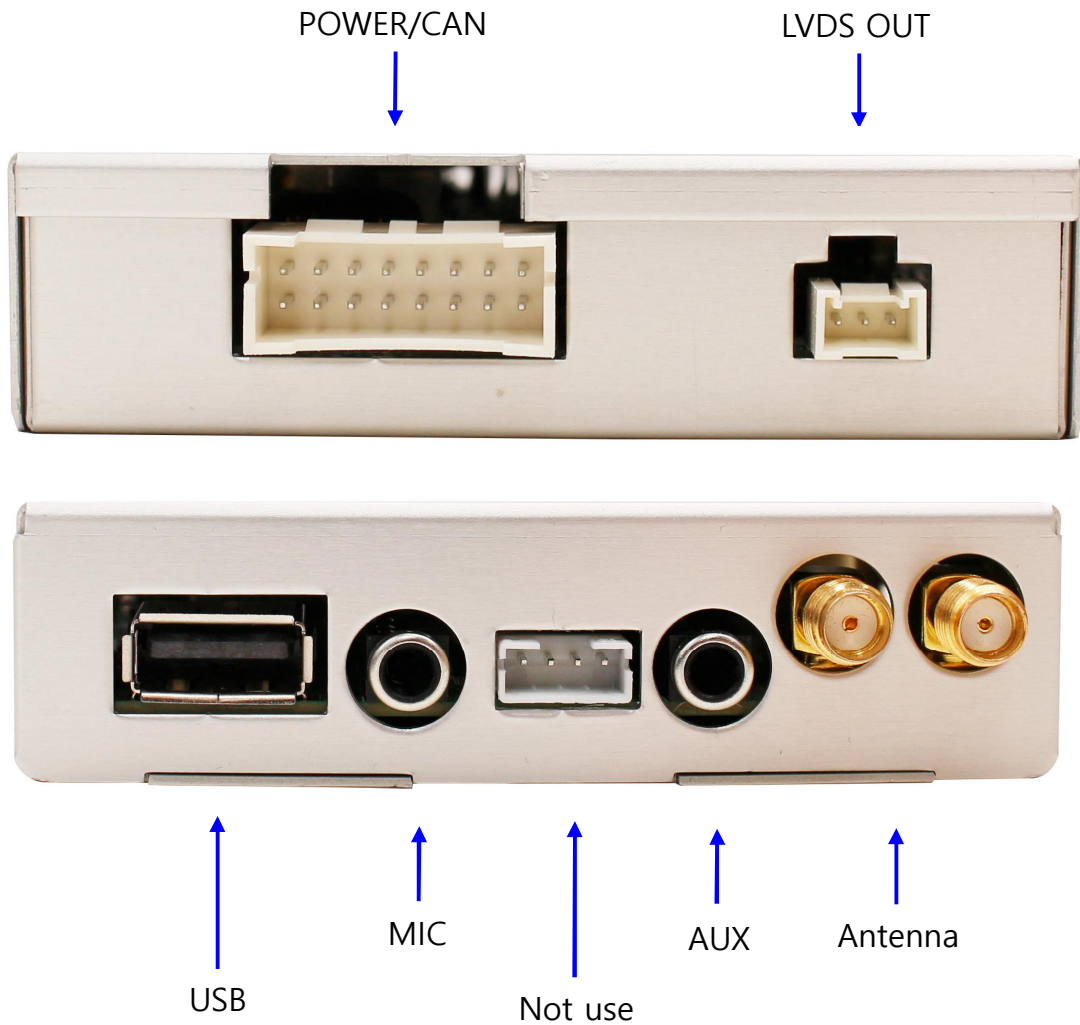

## 5. Connector Pin Assignment

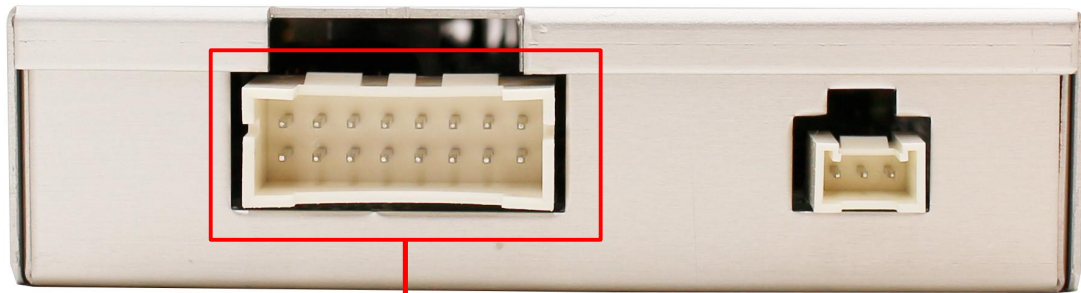

### \*POWER Connect

1	Yellow	White	Green	Grey	White	Red	White	Black	15
2	Yellow	Blue	Orange	Purple	White	White	Green	Black	16

- |                     |                  |
|---------------------|------------------|
| 1. Battery (Yellow) | 9. N.C           |
| 2. Battery (Yellow) | 10. N.C          |
| 3. N.C              | 11. ACC (Red)    |
| 4. KEY1 (Blue)      | 12. N.C          |
| 5. CAN1-L (Green)   | 13. N.C          |
| 6. CAN1-H (Orange)  | 14. Mode (Green) |
| 7. CAN2-L (White)   | 15. GND (Black)  |
| 8. CAN2-H (Purple)  | 16. GND (Black)  |





## 6. Product Composition

---



Interface(Carplay) 1 EA



AUX Cable 1 EA



Power Cable 1 EA



Bluetooth / Wifi Antenna 2EA



LVDS Cable 1 EA



Microphone 1 EA

## 7. DIP S/W Setting

\* ON : DOWN , OFF : UP

PIN	FUNCTION	DIP S/W Selection
1	N.C	
2	N.C	
3	N.C	
4	N.C	
5	N.C	
6	OEM NAVI open.	ON : YES OFF : NO
7	CAR type SEL	Right Picture
8		

\* DIP S/W Example



Discovery4 (D4)  
RangeRover  
RangeRover sports  
Evoque  
FreeLander2  
Jaguar XJ 8" (2011~)  
Jaguar XJL  
Range Rover Vogue(2014~)  
Land Rover Discovery Sports 2.0D SE (2015)



Jaguar XF (2009~2015)

# 7. DIP S/W Setting

Before connecting the interface, set DIP-SW 6 for OEM screen.



## 8. Steering wheel Button

Jauar XF (2009~2015)



Carplay mode TRACK UP

Carplay mode TRACK DOWN

Carplay mode SIRI

# 8. Install Manual

## 1. Installation connection – LVDS/POWER cable

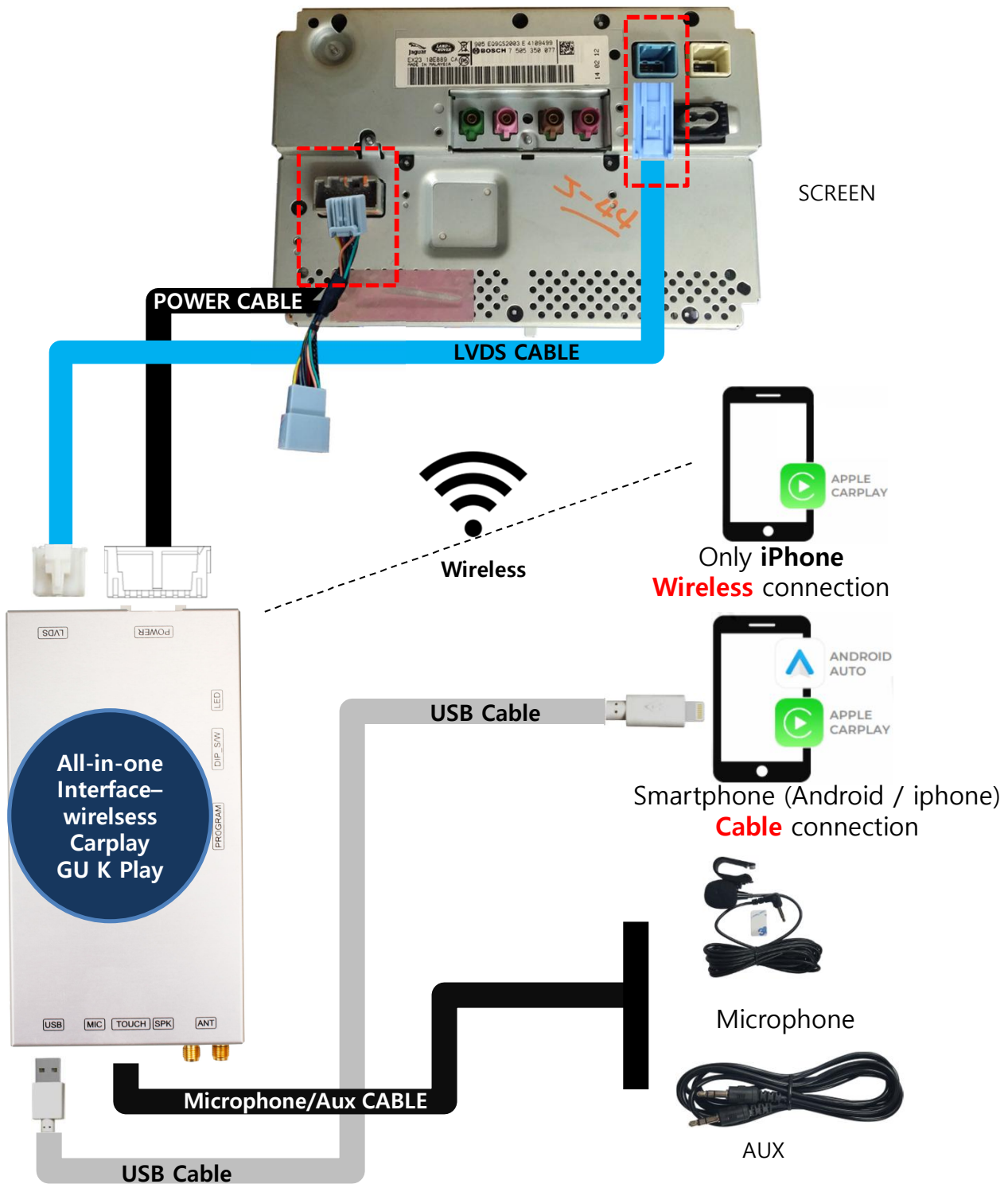



# 8. Install Manual

## 2. Installation - EVOQUE

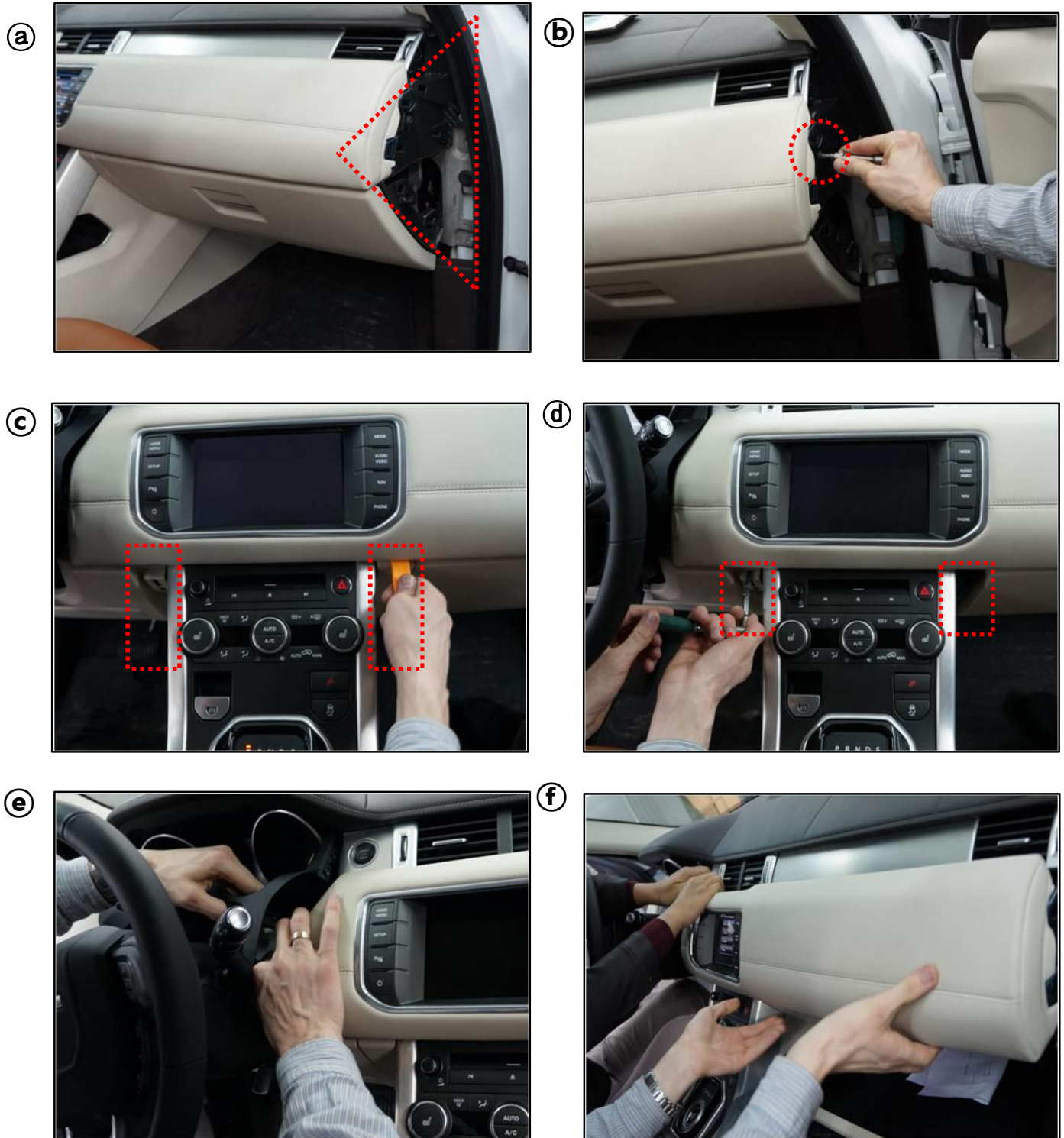

# 8. Install Manual

## 2. Installation – FREELANDER2

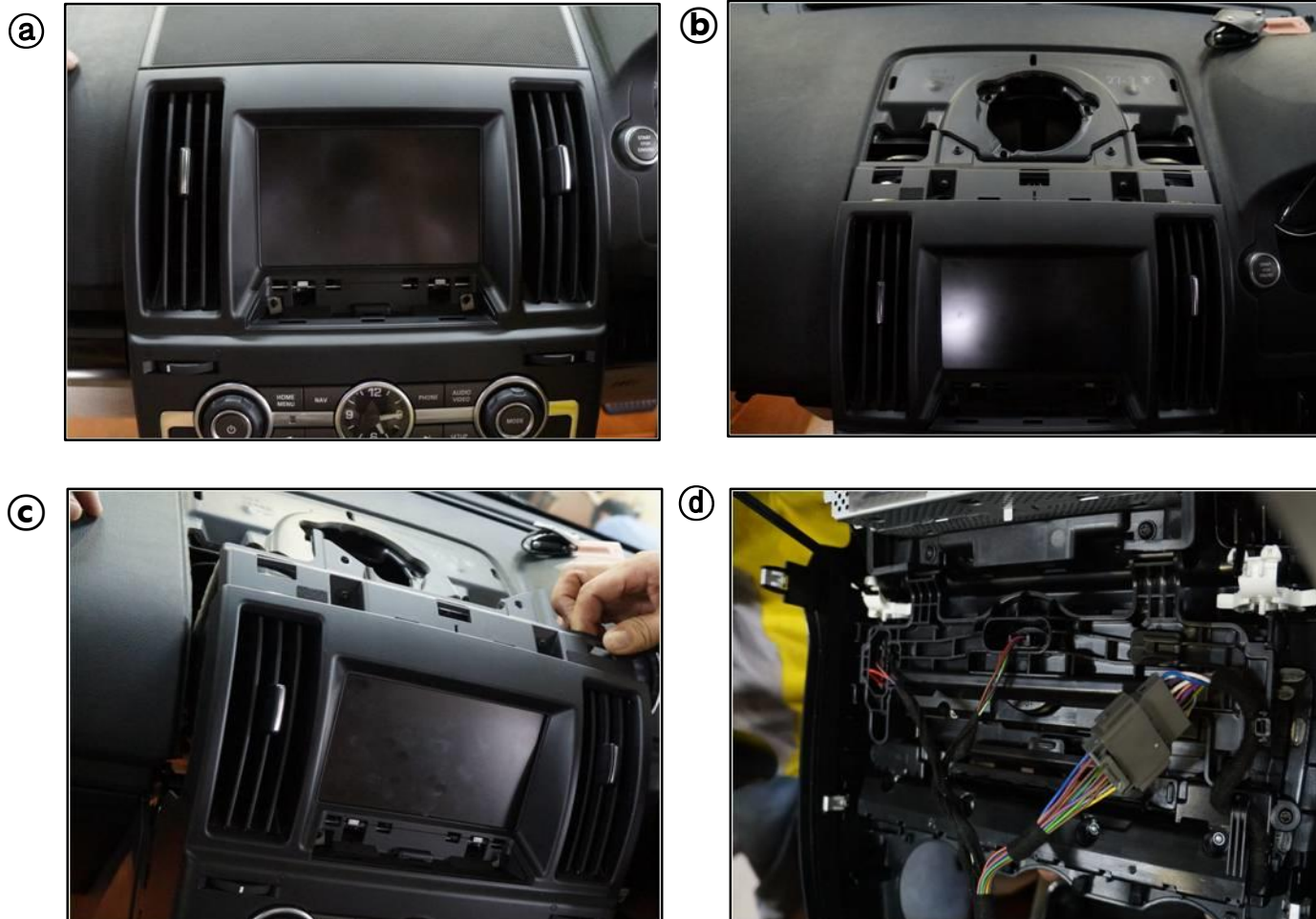

# 8. Install Manual

## 2. Installation – JAGUAR XF

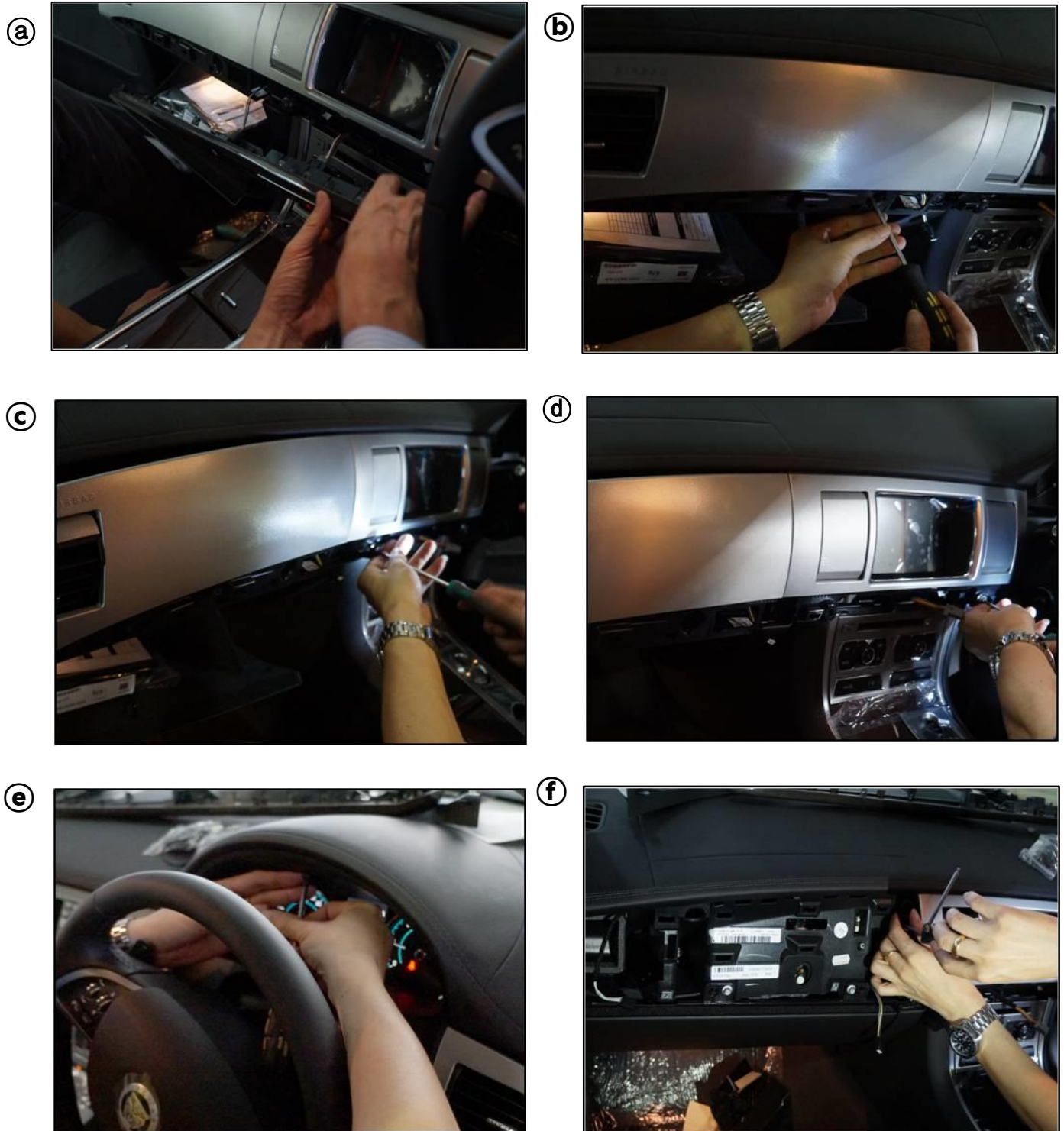



## 9. Q & A

---

### FAQ

1. Not possible to switch mode
  - Check connection of OSD Key pad wire
  - Check CAN connection
2. Display wrong size of picture
  - Check Dip s/w setting
3. Display black screen in OEM mode
  - Check connection of LVDS/LCD cable

### Caution

1. The device must not be installed in where it interferes driving  
(close to brake pedal, steering wheel, airbag etc.)
2. LVDS cable must be connected correctly according to the manual
3. Insulate the end of wire by using electrical tape
4. The installation should be done by expert
5. GU electronic does not take any responsibility for any problem caused by wrong installation
6. If the navigation menu pops up on the OEM navigation screen as shown in the figure below, it can not be installed.

